

How to Throw away Your Recyclable Waste

✓ WHEN? WHERE?

SUN	MON	TUE	WED	THU	FRI	SAT
Standard Garbage Bags		Recyclable Waste	Standard Garbage Bags			



After 8P.M.

- Do not leave garbage bags outside before 8 P.M.

In Front of Your House(Store)

- If you are a resident of an apartment, please contact the management office.

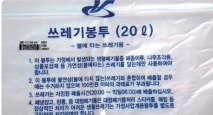
✓ HOW?

Type	Instructions	Notes
General Waste	Use white-colored standard garbage bags. Do not mix it with recyclable waste or food waste!	
Recyclable Waste	Use transparent plastic bags.	

✓ TIPS for Proper Recycling



Empty the contents and rinse with water before you put them out.
Remove the lids and the labels (stickers) made from other materials.
Separate paper cartons (milk cartons, etc.) from other kinds of paper.



Examples of things that cannot be recycled!

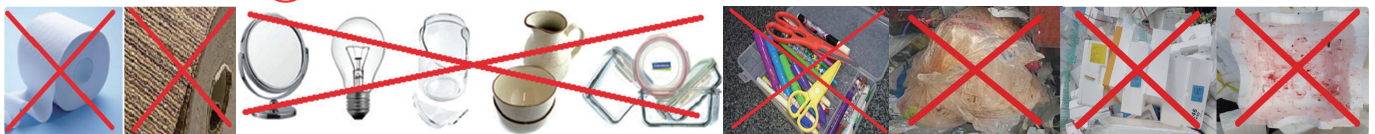

- wet paper, toilet paper, used diapers, etc.
- vinyl (plastic bags) or styrofoam contaminated with food, etc.
They must be thrown in white-colored standard garbage bags purchased at a designated supermarket.
- mirrors, pottery, heat-resistant glass, broken glass, broken lamps, etc.
They must be thrown in green-colored standard garbage bags for incombustible waste purchased at a designated supermarket.
- blankets, pillows, cushions, dolls, bags, shoes, rubber, wood, wallpaper, towels, etc.
They must be thrown in orange-colored standard garbage bags for combustible waste purchased at a designated supermarket or be placed in the designated area with a large waste sticker on them.

- If you have an inquiry about standard garbage bags, please contact ☎ 032-580-1180 (Seogu Facilities Management Corporation)
- If you want to dispose of large electronic appliances at no cost, please contact ☎ 1599-0903

Littering and failure to use standard garbage bags will be punished with a fine of up to ₩1,000,000.



Resource Recirculation Division, Seogu Office, Incheon Metropolitan City
(☎ 032-560-4390)

生活用品垃圾分类方法

✅ 扔垃圾的时间·场所

星期日	星期一	星期二	星期三	星期四	星期五	星期六
重量制塑料袋		回收用品			重量制塑料袋	

扔垃圾的时间：(晚上8点以后~凌晨12点以前)
扔垃圾的场所：在自家(商店)门口

· 所有垃圾，晚上8点以前不许扔。

· 住在楼房的居民咨询管理事务所

✅ 垃圾分类方法

种类	分类方法	例如
一般垃圾	垃圾放在白色重量制塑料袋里 · 回收垃圾和饮食垃圾不能放在一起扔。	
回收用品垃圾	扔回收垃圾时装在透明塑料袋里。	

✅ 生活用品垃圾 分类方法



扔掉里面的脏东西，用水洗干净后扔掉。
其它材质的盖儿，除掉商标(广告贴纸)
纸盒(牛奶纸包装盒)和 一般纸类要分类扔掉。

❌ 不能回收的垃圾。

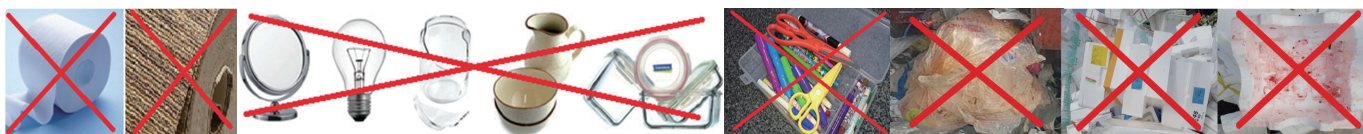

* 湿巾(纸), 纸, 尿不湿 等

* 饮食污染的塑料袋和泡沫等.

购买白色重量制塑料袋，把垃圾装在里面扔掉。

* 镜子, 陶瓷类, 耐热玻璃, 碎玻璃, 碎灯泡, 灯泡 等.

扔垃圾时购买绿色不燃性重量制塑料袋，把垃圾装在绿色不燃性重量制塑料袋里。

* 绵被, 枕头, 垫子, 娃娃, 包, 鞋, 胶皮, 木头, 壁纸, 毛巾, 电褥子, 加热垫 等

扔垃圾时购买可燃性黄色重量制塑料袋，把垃圾装在可燃性黄色重量制塑料袋里，或贴大型废物不粘胶

· 咨询购买重量制塑料袋 ☎ 032-580-1180 (西区设施管理局)

· 咨询大型废物家电免费回收 ☎ 1599-0903

乱扔垃圾，或不可回收垃圾，一般生活垃圾，饮食垃圾放在一起乱扔者罚款韩币100万元。



仁川广域市西区厅资源循环科

(☎ 032-560-4390)